

**Key**

- - - - Demolitions
- Existing fabric
- New Walls
- Area of upgrade

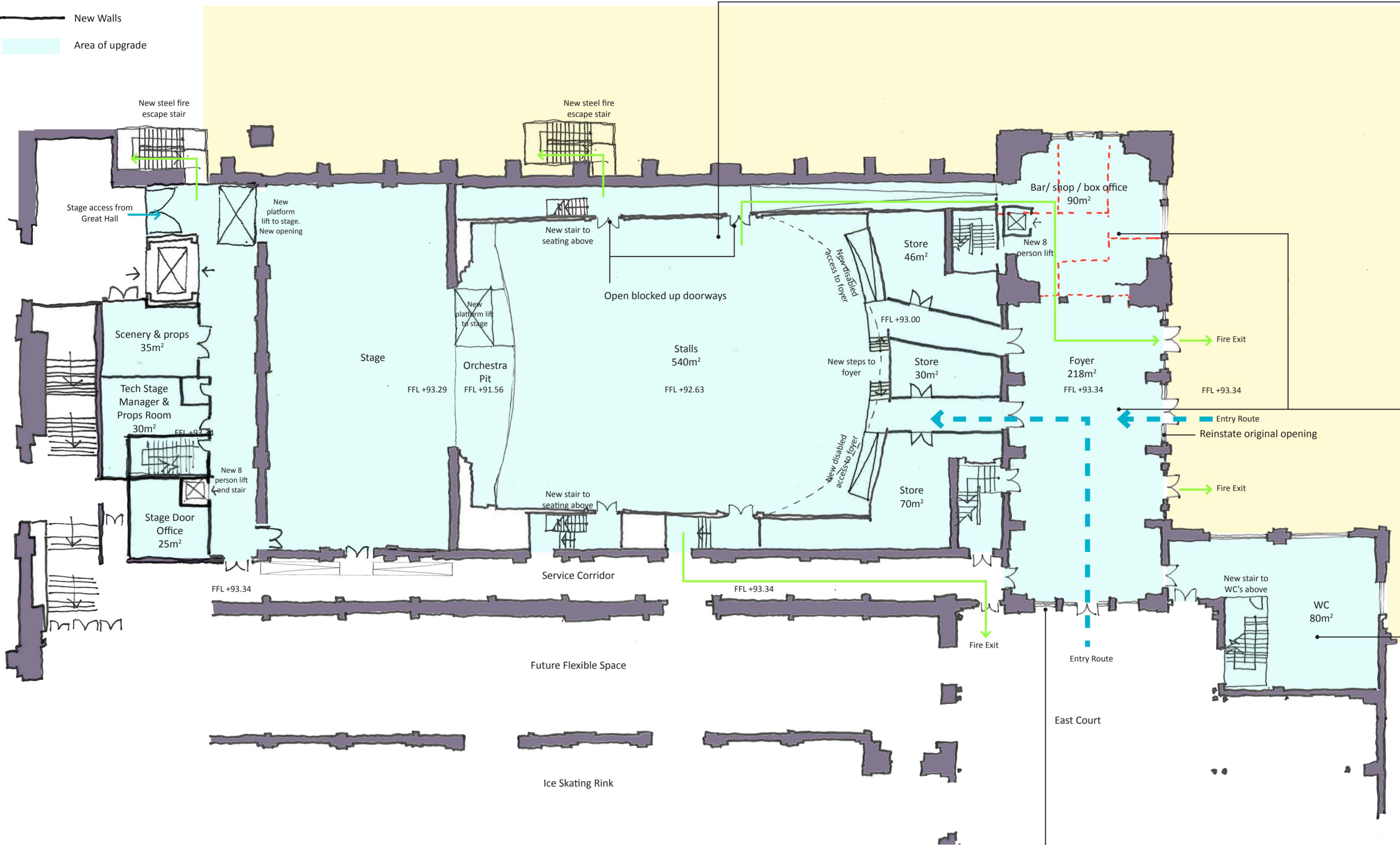

**Theatre**

Floor	Timber Finish Floor structure options: <ul style="list-style-type: none"> <li>As existing with additional steel/timber strengthening</li> <li>New flat concrete construction on support to suit</li> <li>New flat timber construction on support to suit</li> <li>Mechanised floor with additional bleacher seating to rear</li> </ul>
Walls	Remain as existing Acoustic panels to be added TBC by acoustic engineer
Ceiling	Remain as existing Acoustic panels to be added TBC by acoustic engineer
Doors	Doors to be added where required for fire protection
FF&E	New removable theatre seating to be added to theatre consultants spec

**Lobby & Bar**

Floor	Stone Tiles
Walls	Remove redundant services, make good, repaint white
Ceiling	Remove redundant services, make good, repaint white
Windows / Doors	Demolish blocked up original openings add new glazed doors
FF&E	New bar to be added

**WC**

Floor	Ceramic tile
Walls	Remove redundant services, make good, repaint white
Ceiling	Remove redundant services, make good, repaint white
Windows / Doors	Demolish blocked up original openings add new windows
FF&E	All new fixtures and fittings required. All new services required

**TO BE READ IN CONJUNCTION WITH AMPC DRAWINGS**

0 10 20m

**First Floor**  
 Scale: 1:200 @ A2  
 Theatre - Masterplan Positive Scheme Study  
 Alexandra Palace Theatre & BBC Studios HLF Bid

Enlarge openings back to heritage structure

SK AXP1-008  
 Rev B  
 6th September 2012

**FARRELLS**